

# IP-7S-RS-R40

## 7-Slot Backplane with 4 PCI and 2 ISA Bus User Manual Ver. 4.0

### 1. P8: AT Power Connector

Pin	Description
1	PWRGD
2	+5V
3	+12V
4	-12V
5	GND
6	GND

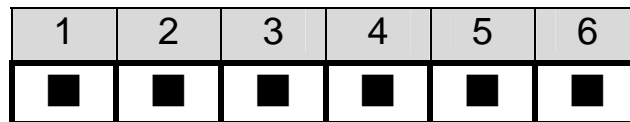

### 2. P9: AT Power Connector

Pin	Description
1	GND
2	GND
3	-5V
4	+5V
5	+5V
6	+5V

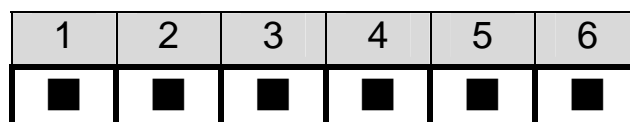

### 3. CN1, CN2: Fan Connector

Pin	Description
1	NC
2	+12V
3	GND

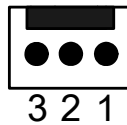

### 4. CN4: Voltage Connector

Pin	Description
1	+5V
2	-5V
3	-12V
4	+12V
5	GND

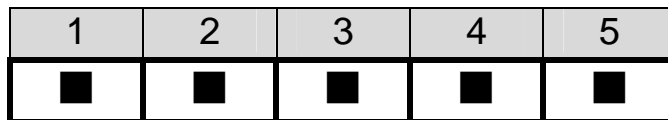

### 5. PCI routing table:

PCI SLOT	PCI1	PCI2	PCI3	PCI4
IDSEL	AD19	AD20	AD21	AD22
REQ#	REQ0#	REQ1#	REQ2#	REQ3#
GNT#	GNT0#	GNT1#	GNT2#	GNT3#
INTA	A	D	B	C
INTB	B	A	C	D
INTC	C	B	D	A
INTD	D	C	A	B

6. Notice:

- a. Recommend to use 6mm width spacer to install

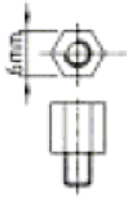

- b. Torsion must less than 6lb-inch

7. Dimension:

