



**IEI Integration Corp.**



## **EBC-2200**

### **EPIC-NANO Series Embedded Board Chassis**

## **Quick Installation Guide**

Version 1.0 Mar 31, 2015

---

### **Packing Content**



**A. Chassis x 1 pcs**



**B. QIG**



**C. Screws**



**D. Wall Mounting Kits**



**E. wireless antennas (optional)**



**F. Power Adapter with Power Cord**

Product Dimensions

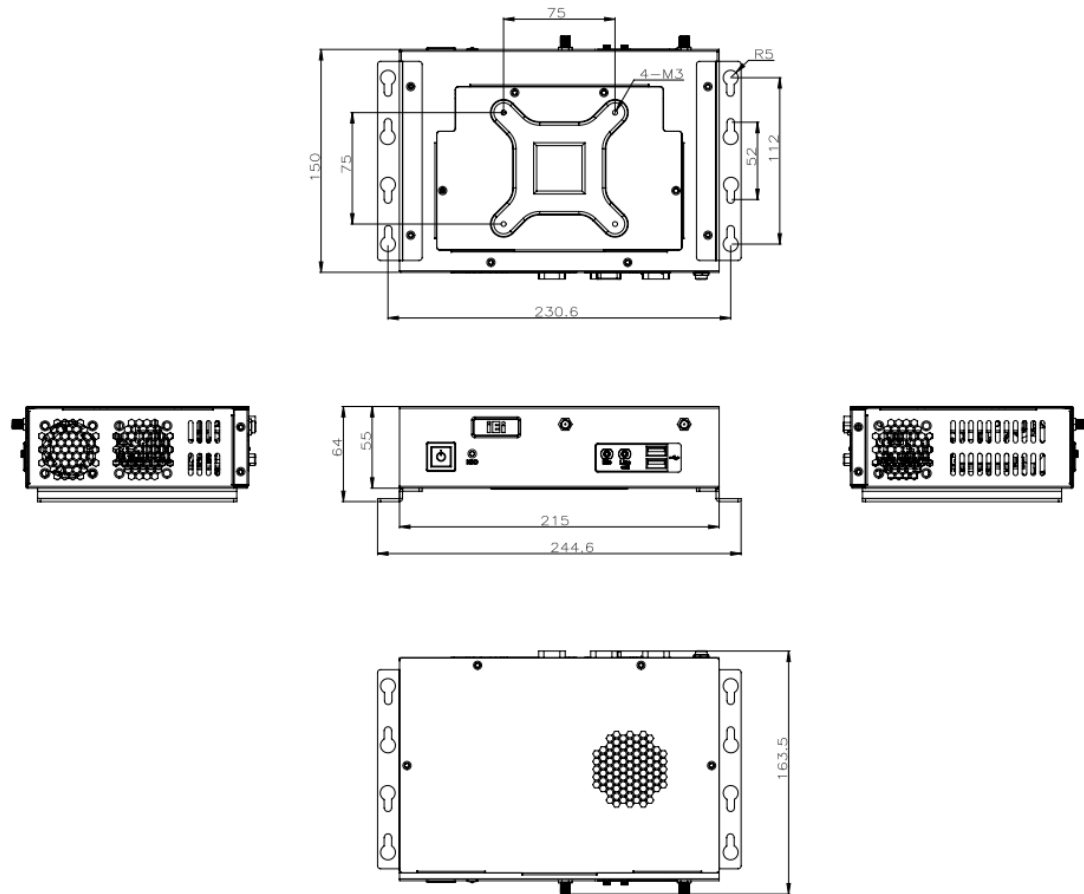

Product Specification

Model Name	EBC-2200-BT-R10	EBC-2200-QM87-R10
Chassis		
Color	Black	
Chassis Construction	Sheet metal	
Motherboard		
Motherboard model	NANO-BT-i1-J19001-R10	NANO-QM871-C-R10
CPU	Intel® Celeron® J1900 on-board SoC (2GHz, quad-core, 2MB cache, TDP=10W)	Intel® mobile Celeron® 2000E on-board processor (2.2GHz, dual-core, 2MB cache, TDP=37W)
Chipset	SoC	Intel® QM87

System Memory	One 204-pin 1066/1333MHz DDR3L 4GB SO-DIMM pre-installed ( system max 8GB)	One 204-pin 1066/1333MHz DDR3 4GB SO-DIMM pre-installed ( system max 8GB)
iRIS solution	1 x iRIS-1010 slot	N/A
Ethernet	2 x RJ-45 LAN1: Intel® I210-AT PCIe controller with NCSI support LAN2: Intel® I211-AT PCIe controller	2 x RJ-45 LAN1: Intel® I217LM PHY with Intel® AMT 9.0 support LAN2: Intel® I211-AT PCIe controller
Storage		
Hard Drive	1 x 2.5" SATA 6Gb/s HDD/SSD drive bay	
I/O interfaces		
PS/2	Real IO : 1 by real	N/A
USB 3.0	Real IO : 1 by real	Real IO : 2 by real
USB 2.0	Front IO: 2 by cable Rear IO: 1 by real	Front IO: 2 by cable Rear IO: 2 by real
RS-232	Rear IO: 2 by cable	Rear IO: 2 by cable
RS-422/485	Rear IO: 1 by cable	Rear IO: 1 by cable
Digital I/O	N/A	Rear :1 by cable
Display	1 x HDMI 1 x VGA	2 x HDMI 1 x VGA
Resolution	VGA (up to 2560x1600@60Hz) HDMI (up to 2560x1600@60Hz)	VGA (up to 1920x1200@60Hz) HDMI (up to 2500x1600@60H)
Audio	1 x Line out 1 x Mic in	
LED indicator	Power HDD	
Wireless	802.11b/g/n 2T2R (optional)	
Expansions		

PCIe Mini	1 x Full-size PCIe Mini card slot (support mSATA co-lay SATA port 2)	1 x Full-size PCIe Mini card slot (supports mSATA, SATA 6Gb/s signal only)
Power		
Power Input	DC Jack : 12V DC	
Power Consumption	12V@1.52A	12V@4.78A
Reliability		
Mounting	Wall mount ; VESA 75	
Operating Temperature	0°C ~50°C with air flow (SSD),5% ~ 95%, non-condensing	
Operating Shock	Half-sine wave shock 5G, 11ms, 3 shocks per axis	
Operating Vibration	MIL-STD-810F 514.5C-1 (with SSD)	

## Hardware Installation

The following procedures demonstrate the installation of EBC-2200. Please read the precautions carefully before installing it.

### Precautions

1. Always disconnect the unit from the power outlet whenever installing or fixing a component inside the chassis.
2. If possible, always wear a grounded wrist strap when installing or fixing a component inside the chassis.
3. Hold electronic circuit boards (EPIC-NANO board) by the edges only. Do not touch the components on the board unless it is necessary.
4. Use the correct screws and never overly tighten them.
5. Keep the whole set original package in case the unit has to be returned.

### Step 1

Remove eight screws from the cover and I/O bracket by screwdrivers.



### Step 2

An optional 40mm cooling fan can accommodate in EBC-2100. The arrow sign on the cooling fan indicates the direction of airflow and it should point outside the chassis.



**Step 3**

Before installing CPU board into the chassis, CPU, Memory, heatsink and CPU cooling fan must be secured properly onto the CPU board. To prevent heatsink deformation, please handle the heatsink diagonally.

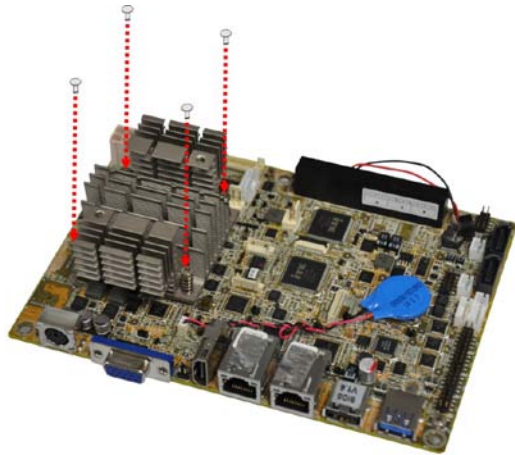
**Step 4**

Align the motherboard with the chassis standoffs, secure with screws for motherboard, I/O bracket, COM port and VGA port.

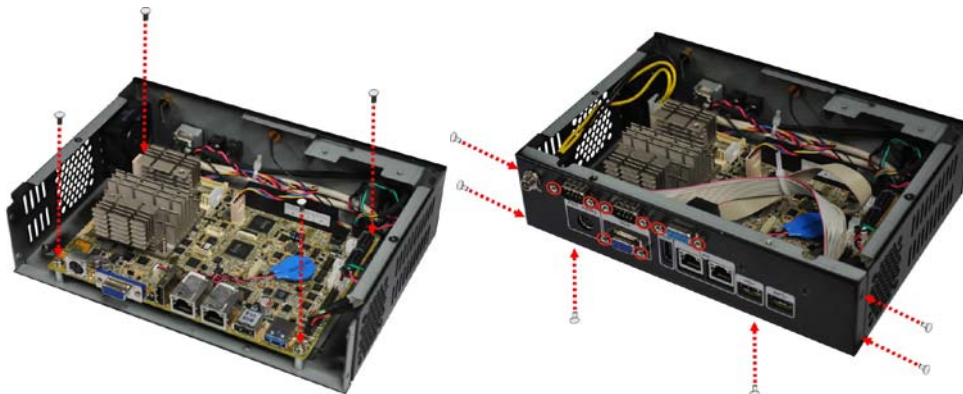
**Step 5**

If additional hard drive storage is required, simply remove the HDD bracket from the chassis. Then connect the hard drive to the HDD bracket, plug the HDD cable to the hard drive, and assemble the HDD bracket with HDD back into the chassis.

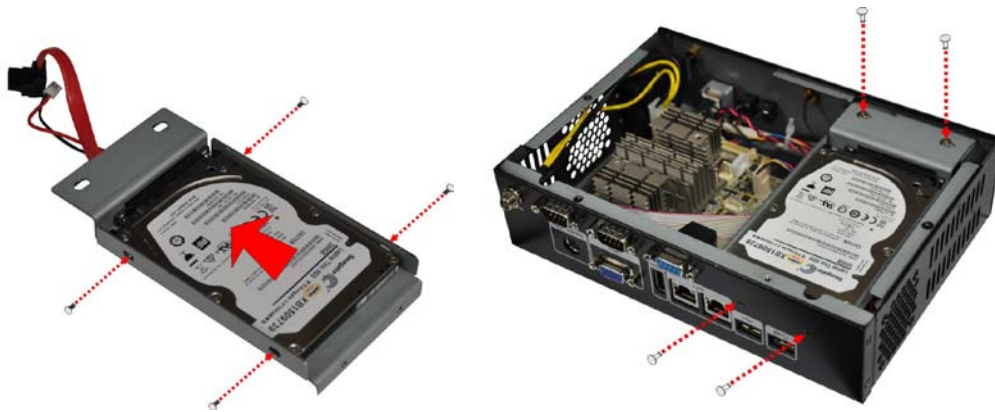

**Step 6**

Place the cover back on the top of the case and secure with screws.



**Step 7**

When replacing the system memory, simply remove the screws on the bottom cover then insert the memory to the memory slot. Then place the cover back on the chassis and secure with screws.



**Step 8**

If wall mounting is required, secure the wall mounting kits to the bottom of the chassis with screws.



## Contact Information

### IEI Integration Corp.

TEL : 886-2-86916798

FAX : 886-2-66160028

Email: [sales@iei.com.tw](mailto:sales@iei.com.tw)

Website: <http://www.ieworld.com>

Address: No. 29, ZhongXing Rd., Xizhi Dist., New Taipei City, 221, Taiwan